

Thin Client

WebDT 160

Modular Thin Platform for Embedded Applications



Key Features:

- Support for Windows® CE and Windows® XP Embedded
- DVI port, DVI-VGA adapter
- Integrates major thin-client/server computing protocols (Citrix ICA, Microsoft RDP), terminal emulation suite; and web browsers
- Comprehensive, easy remote device administration through server-based *WebDT Manager* software
- Small form factor for space-saving, desktop and mounted deployments
- Fan-less, flash memory-based with no moving parts
- Custom bracket for VESA-compliant mounting to LCD displays and VESA mounts
- Available options for wireless networking; USB-to-Serial and USB-to-PS/2 ports

WebDT 160

DT Research designs and manufactures a comprehensive line of network-ready information appliances, enabling secure and reliable access to the Internet and applications anytime, anywhere. The **WebDT 160** offers expanded graphics capabilities for multimedia applications, as well as efficient design for space-strained environments.

The Product

The **WebDT 160** features the integration of the powerful and energy efficient 1.5GHz x86 processor into a compact and robust enclosure. The **WebDT 160** provides a DVI (digital video interface) port and a VGA adapter for optimal display experience, and has an optional miniPCI adapter for internal wireless. With options for wireless networking and VESA-compliant mounting, the **WebDT 160** is perfect for cable-free and space-saving applications. With durable, fan-less construction, the **WebDT 160** provides quiet and reliable operation and extended operating life, lowering the total cost of ownership.

Applications

- ▶ Inventory and Warehousing
- ▶ Manufacturing
- ▶ Finance
- ▶ Control and Monitoring
- ▶ Education
- ▶ Healthcare
- ▶ Retail
- ▶ Hospitality

Highlights

- Digital video interface port with VGA adapter
- High-integration and energy-efficient processor technology
- Robust and fan-less construction for quiet and reliable operation

Major Options

- Internal 802.11 wireless adapter
- USB-to-Serial and USB-to-PS/2 adapters 1 2
- External Bracket 3 for Mounting to VESA adapters and LCD monitors
- Short VGA cable for connection to mounted display
- Low-cost computing in compact and versatile packaging

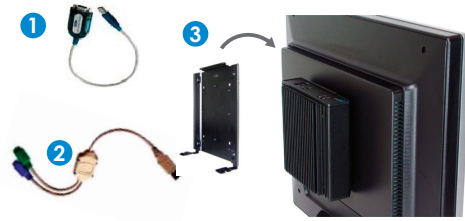

Standard Package and Accessories

- One (1) WebDT 160 4
- AC/DC Adapter 5
- VGA Adapter 6
- Documentation



Specifications

Processor	1.5 GHz x86 Processor
Display Resolution	Up to 1600 x 1200
Storage	4GB/ 8GB/ 16GB (Industrial Flash)
RAM	1GB
Operating Systems	Windows® CE; Windows® XP Embedded
Enclosure	Aluminum chassis; ABS Plastic end-caps
Expansion	Mini-PCI (internal); USB
Control Buttons	One (1) front Power button
Input/Output Ports	12V DC-in Jack; Microphone-In; Audio-Out Jack; USB 2.0 Ports (4); 10/100 BaseT Ethernet; DVI-I
AC/DC adapter	Input: 100–240VAC; Output: 12VDC
Power Cords	North America, EU, UK, China
Dimensions (H x W x D)	1.7 x 5.5 x 5.1 (in); 43 x 140 x 130 (mm)
Base Weight	1.2lb (544g)
Regulatory	FCC Class B, CE, C-tick, RoHS compliant
Operating Temperature	0° – 40°C
Humidity	0% – 90% non-condensing

* Specifications subject to change without notice.